

Plans for Scotland's first new University campus for the 21st Century, to be built at Craighall, Musselburgh

Queen Margaret University College is planning to move to Musselburgh, bringing many economic benefits to the town and also providing exciting new facilities for the community to enjoy.

This exhibition shows the proposed layout for the 35-acre site at Craighall, and artist's impressions of how the new campus might look when it is built.

The aim is to create a vibrant new 21st century academic village with high-tech buildings and attractive landscaped parkland spaces. In addition, there will be cafes, shops, health clinics utilising clinical expertise, and sports and leisure facilities. Members of the local community will be encouraged to use the facilities on offer at the new campus, including the Learning Resource Centre which forms the heart of the campus.

These plans have been developed following initial

consultancy with the community. In particular, environmental issues have been fully considered and the aim is to create a green environment in which to live and work. From construction, to future operation and maintenance, sustainability is at the heart of every aspect of this project from creating homes for local wildlife to providing plenty of open green space for everyone to enjoy.

Building is due to start in summer 2005, with completion in 2007.

We welcome your views on these proposals and would be grateful if you would take a little time to complete the 'Your Views' section overleaf or write to:

Rosalyn Marshall, Vice Principal,
Queen Margaret University College,
Clerwood Terrace, Edinburgh EH12 8TS



Above - General view of academic building in context, showing relationship to heart of university square.

Right - Interactive social hub with view towards Learning Resource Centre.

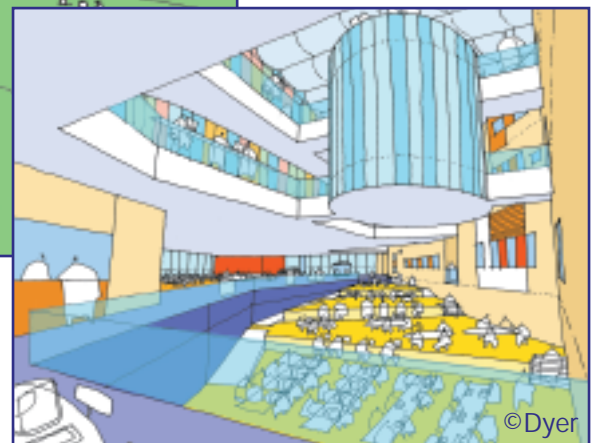

About Queen Margaret University College

Queen Margaret University College provides vocationally relevant education, research and consultancy in the fields of: business and enterprise; drama and creative industries; health studies; and social sciences, media and communication. We are committed to innovation, participation and lifelong learning. With around 4,500 students, our comparatively small size allows us to offer our students a highly supportive environment, and we aim to serve the community as a whole.

How the new campus will benefit the community

- ✓ Queen Margaret University College is estimated to bring a £32 million boost to the local community.
- ✓ Employment attributable to the Institution is around 1200 and there will be around 500 jobs on site during the construction phase
- ✓ Opportunities for flexible, 24/7 learning
- ✓ A park environment including a biodiversity garden, walks and ponds
- ✓ Access to the high-tech Learning Resource Centre
- ✓ Sports facilities
- ✓ Health clinics providing physiotherapy, podiatry etc

YOUR VIEWS

Queen Margaret University College (QMUC) would like to know your views on their relocation to Musselburgh. We hope you will spare a few minutes to complete the form below to let us know what you think about the project.

Do you think that having QMUC in Musselburgh will be beneficial to the town's economy and wellbeing?

- YES
- NO

What aspects of the proposals are you most interested in?

- EDUCATION FACILITIES
- QMUC COURSES AND DEGREES
- COMMUNITY LINKS
- LEARNING RESOURCE CENTRE
- SUSTAINABLE CAMPUS
- SPORTS PROVISION
- TRANSPORT LINKS
- EMPLOYMENT OPPORTUNITIES

Are you interested in attending further information events?

- YES
- NO

Did you find this evening's event informative?

- YES
- NO

Where did you first find out about QMUC?

What other information about the planned relocation do you think would be useful?

Would you be interested in joining a community forum to help ensure the campus integrates with the existing community?

- YES (please fill in your contact details below)
- NO

Do you have any other comments?

Your name & address (optional)

Can we contact you with more information about QMUC's relocation?

- YES
- NO

PLEASE RETURN TO:

Susan Woodman, RE:LOCATE Project Administrator
Queen Margaret University College, Clerwood Terrace, Edinburgh EH12 8TS
tel: 0131 317 3469 email: swoodman@qmuc.ac.uk web: www.qmuc.ac.uk